

# meyJOIST

## INSTALLATION REFERENCE SHEET

The meyJOIST Install Reference Sheet contains common requirements for meyJOIST floor system installation used in houses. For detailed design or items not included, the meyJOIST Product Manual should be consulted by scanning the QR Code over the page, or at [www.meyertimber.com.au](http://www.meyertimber.com.au)

### BASIC REQUIREMENTS

- **STORAGE** - meyJOIST should be stored level and dry at least 150mm clear of the ground.
- **JOIST LOCATION** - As per floor layout (if supplied) and not to be spaced further than specified.
- **FIXING TO SUPPORTS** - Use 2/3.06Ø nails per support. Supports to be dry, level, & rigid. Moisture Barriers are recommended if supporting directly on masonry. Provide bearing across full width of meyJOIST.
- **FIXING OF FLOORING** - Flooring should be secured to meyJOIST using screws or ring/twist shank nails recommended for the particular flooring type. Flooring adhesive must be used in conjunction with fasteners to minimise any chance of long term floor squeak. Refer to **factsheet** for more advice.
- **CONSTRUCTION LOADS** - Lateral restraint blocking and floor sheeting **MUST** be installed before applying any construction loads. Refer to **Product Manual** or **factsheet** for advice on allowable loading and locations.

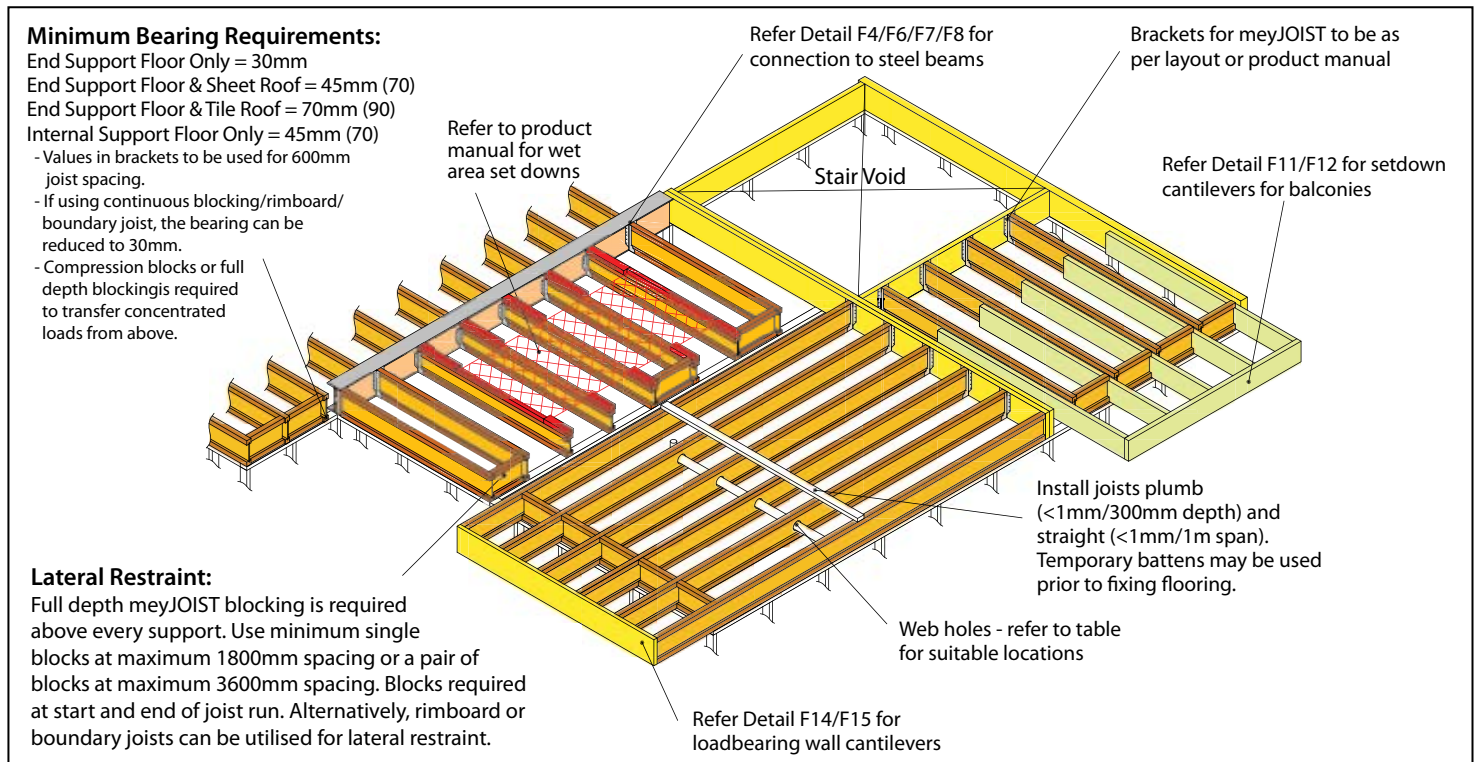

### MINIMUM DISTANCE (in mm) TO FACE OF SUPPORT FOR HOLES AT 450mm JOIST SPACING

LOADING: DEAD LOAD = 100 kg/m<sup>2</sup> and LIVE LOAD = 1.5 kPa/1.8 kN

meyJOIST	SUPPORT	MINIMUM EDGE DISTANCES TO FACE OF SUPPORT (mm)			
		HOLE DIAMETER (mm)		RECTANGULAR (mm)	
		80	125	150x300	200x300
MJ200 45	End (X)	300	N/S		
	Intermediate (Y)		N/S		
MJ240 45	End (X)		300	750	N/S
	Intermediate (Y)		800	1500	
MJ240 90	End (X)		300	1050	
	Intermediate (Y)		1600	2100	
MJ300 45	End (X)	300	380	550	
	Intermediate (Y)		1450	1700	
MJ300 90	End (X)		300	1000	
	Intermediate (Y)		1450	2100	

#### NOTES:

1. "Intermediate" refers to internal supports of continuous span joists. All other cases shall be treated as "End" supports.
2. Locate hole at mid-span if X or Y value exceeds half span.
3. The above values are based on the maximum span that each joist can support.
4. Use MJ240 90 values for MJ240 63 and MJ255 63. Use MJ300 90 values for MJ300 63, MJ360 63 and MJ360 90.
5. I-Joist Hole Support bracket (IHS) may allow holes closer to the support. See meyJOIST product manual for more information.

#### GENERAL HOLE INFORMATION:

1. No holes above 40mm allowed in red zone.
2. No more than 3 holes above 75mm in any one span.
3. Holes 40mm diameter or smaller allowed anywhere in web with minimum 2D distance between holes.

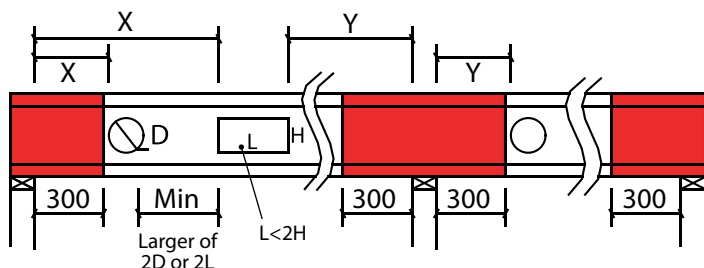

### NOTCHING or TAPERING meyJOIST FLANGES

Do not cut beyond the line of support

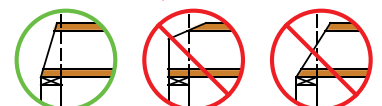

Do not drill or notch flanges



# SELECTED meyJOIST DETAILS

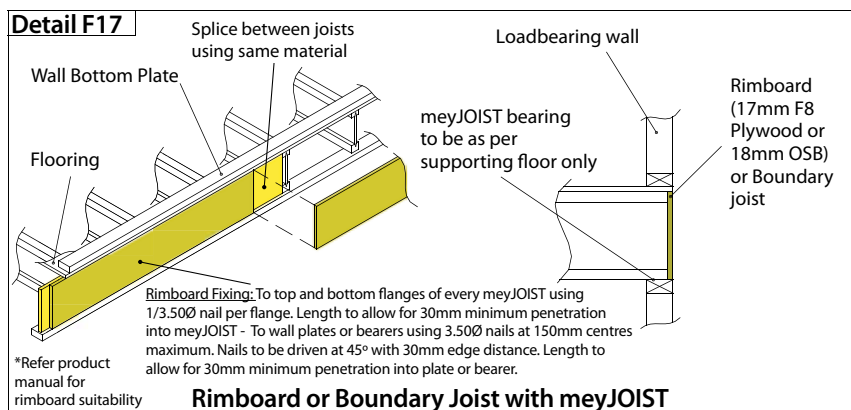
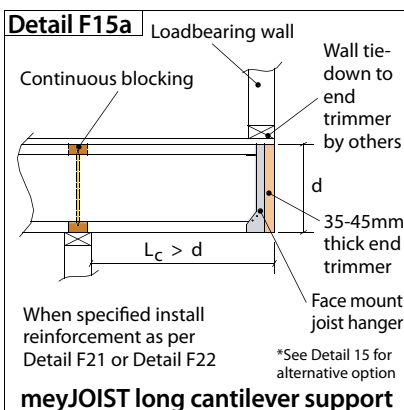
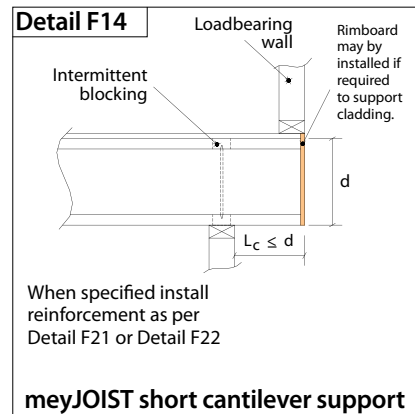
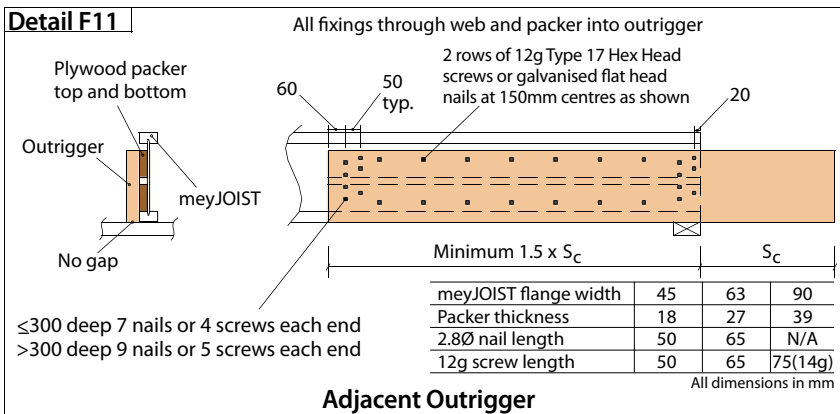
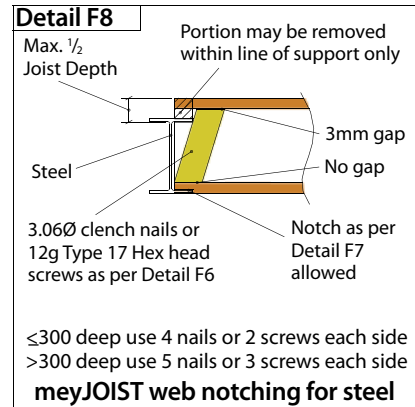
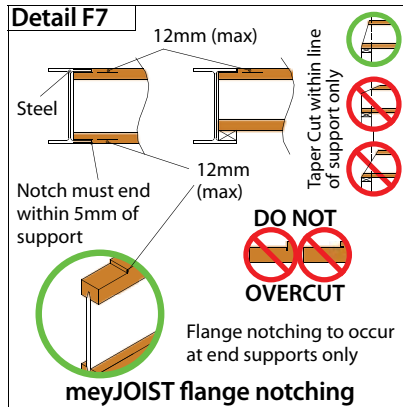
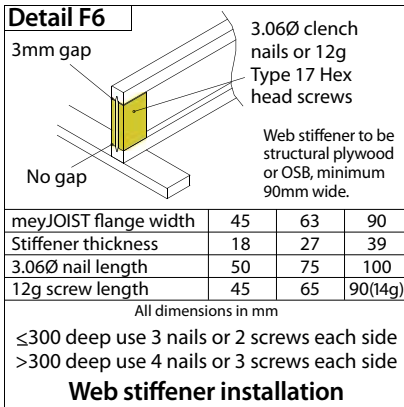
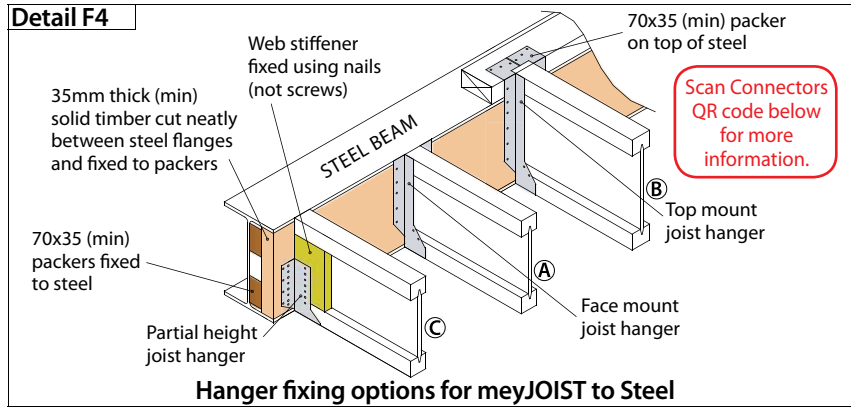
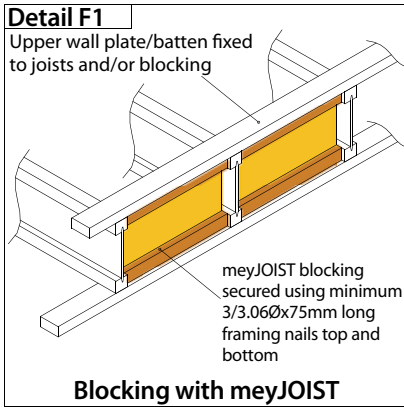

For other details not shown above, refer to the meyJOIST Product Manual.

**Meyer**  
**TIMBER**



**Meyer**  
**TIMBER**  
Victoria

**Meyer**  
**TIMBER**  
New South Wales

**Meyer**  
**TIMBER**  
Queensland

**Meyer**  
**TIMBER**  
Tasmania

